



WERLATONE

SINCE 1965

Werlatone, Inc.  
17 Jon Barrett Road  
Patterson, New York 12563  
T 845.278.2220  
F 845.278.3440  
www.werlatone.com

# 40 dB Dual Directional Coupler

## Model C6290

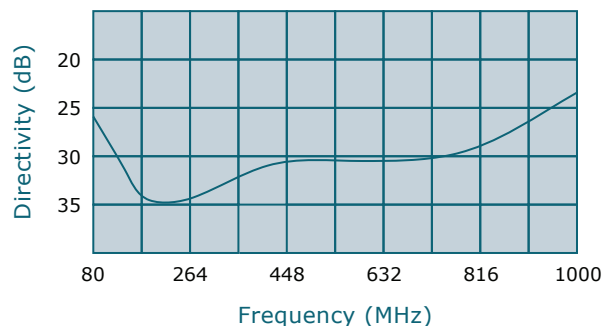
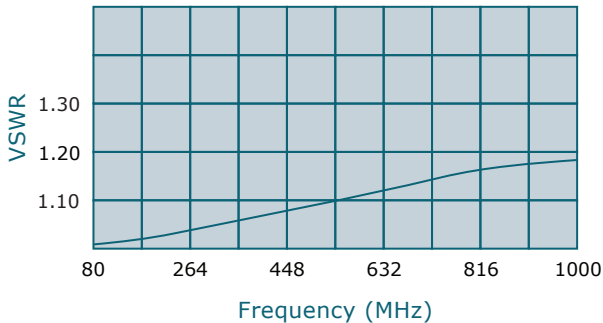
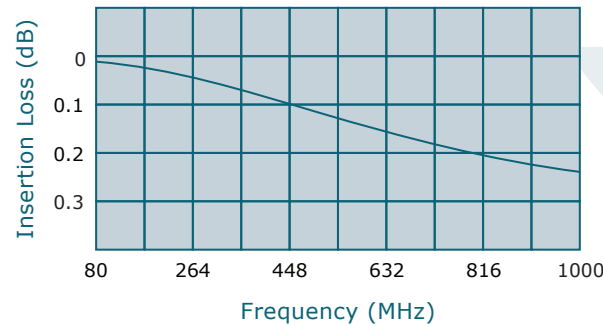
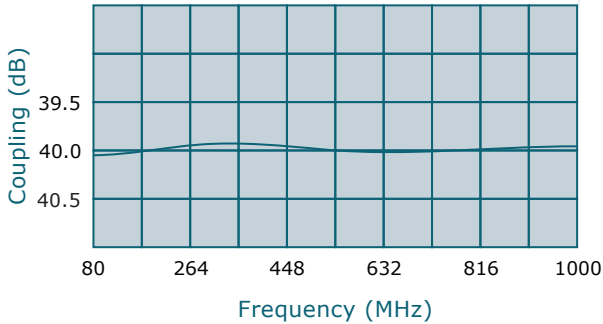

Frequency: 80 - 1000 MHz

Power: 100 W CW

Coupling: 40 dB ± 1.0 dB Nom.

Insertion Loss: 0.25 dB Max.

VSWR: 1.20:1 Max.

Flatness: +/- 0.5 dB Max.

Directivity: 20 dB Min.

\*Mismatch Tolerant® Design

- All specifications guaranteed.
  - Test data provided with each unit shipped.
  - Uni-Directional version available.
- \* Designed to operate, at rated power, into an infinite VSWR.

Connector Configurations		
Model	J1,J2 (Mainline)	J3,J4 (Coupled Port)
C6290-10	N Female	N Female
C6290-12	N Female	SMA
C6290-13	N Female	BNC
C6290-102	SMA	SMA

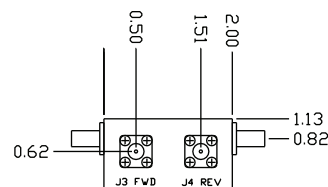
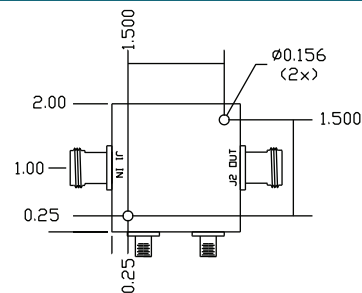

\*\*Subject to change without notice

high power RF devices