



WERLATONE

SINCE 1965

Werlatone, Inc.
17 Jon Barrett Road
Patterson, New York 12563
T 845.278.2220
F 845.278.3440
www.werlatone.com

2-Way(90 Deg.)Combiner

Model QH6031

Frequency: 20-500 MHz

Power: 200 W CW

Insertion Loss: 0.6 dB Max.

VSWR: 1.4:1 Max.

Isolation: 20 dB Min.

Phase Balance: 10 Deg. Max.

Amplitude Balance: 0.3 dB Max.

- All specifications guaranteed.
- Test data provided with each unit shipped.
- Alternate connector configurations upon request.

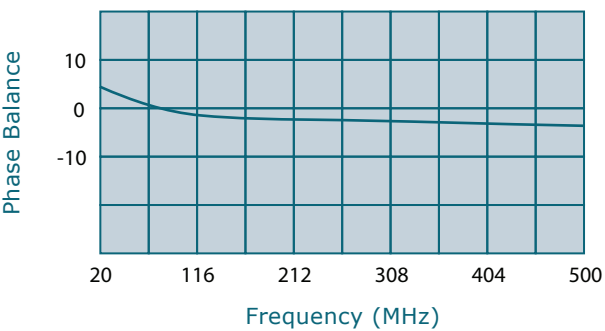
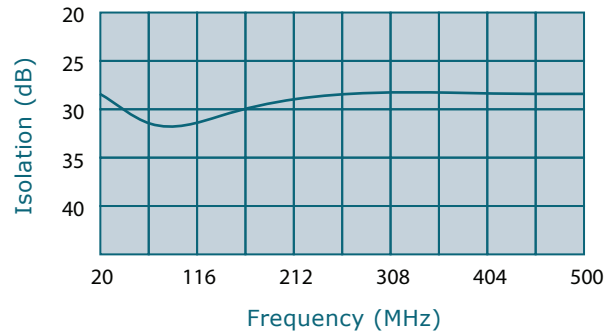
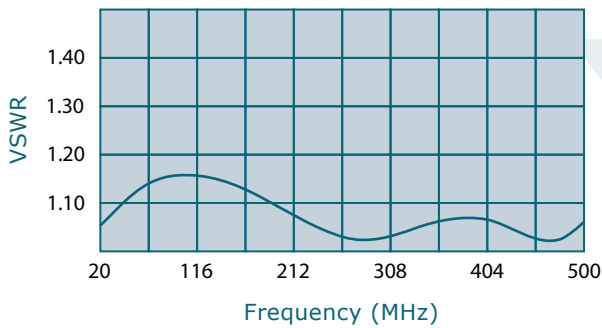
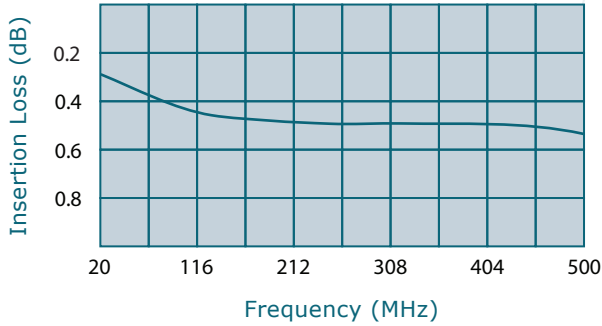

Connectors

Model	J1	J2-J3
QH6031-10	N Female	N Female
QH6031-12	N Female	SMA
QH6031-13	N Female	BNC
QH6031-102	SMA	SMA

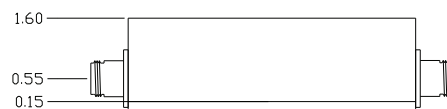
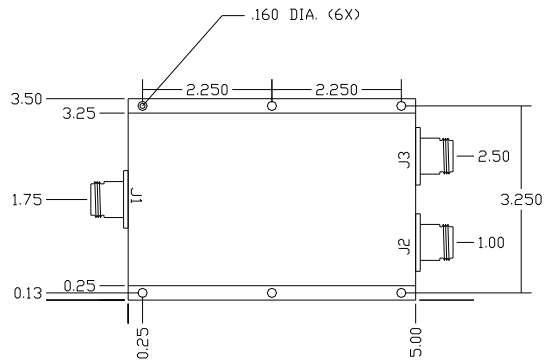

high power RF devices