



WERLATONE

SINCE 1965

Werlatone, Inc.
17 Jon Barrett Road
Patterson, New York 12563
T 845.278.2220
F 845.278.3440
www.werlatone.com

2-Way 180° Combiner/Divider

Model H3670

Frequency: 200 - 400 MHz

Power: 400 W CW

Insertion Loss: 0.2 dB Max.

VSWR: 1.40:1 Max.

Isolation: 20 dB Min.

Phase Balance: 180° ± 5° Max.

Amplitude Balance: 0.2 dB Max.

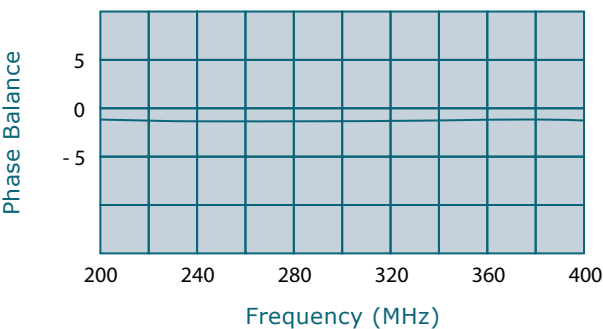
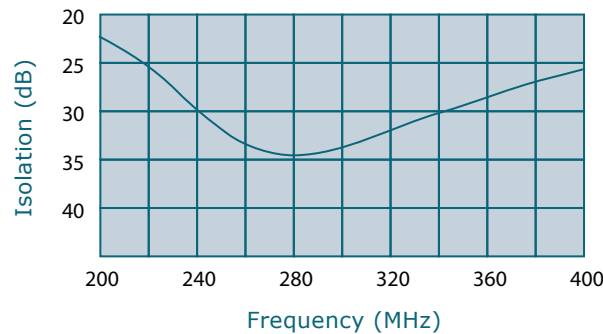
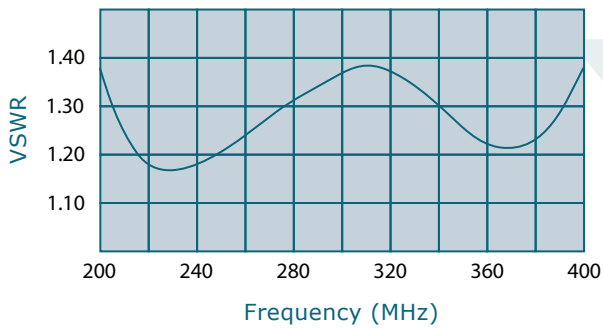
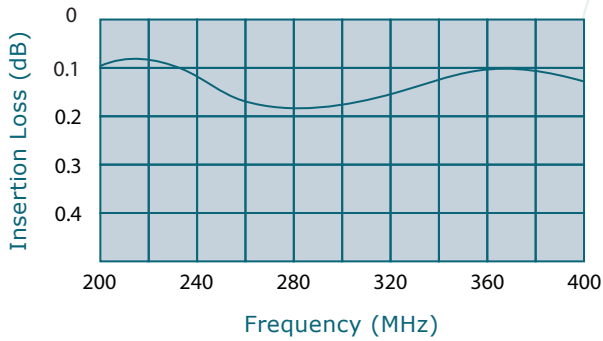

- All specifications guaranteed.
- Test data provided with each unit shipped.
- Alternate connector configurations upon request.

Connector Configurations		
Model	J1 (Sumport)	J2-J4 (Inputs/Outputs)
H3670-10	N Female	N Female
H3670-12	N Female	SMA
H3670-13	N Female	BNC
H3670-102	SMA	SMA

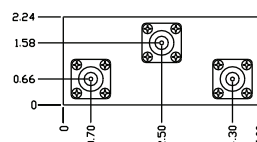
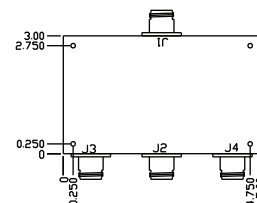
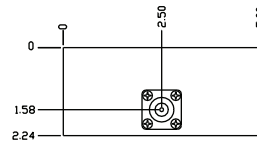

**Subject to change without notice

high power RF devices