



WERLATONE

SINCE 1965

Werlatone, Inc.  
17 Jon Barrett Road  
Patterson, New York 12563  
T 845.278.2220  
F 845.278.3440  
www.werlatone.com

## 2-Way Uneven(6 dB) Divider

### Model C5878

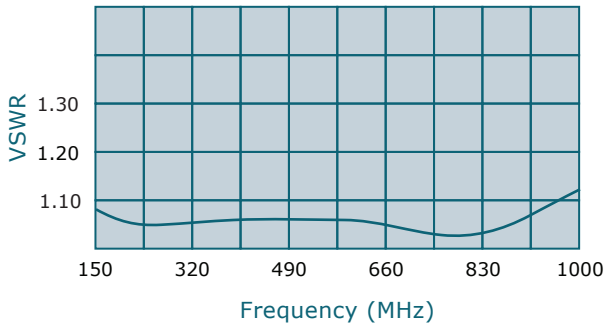
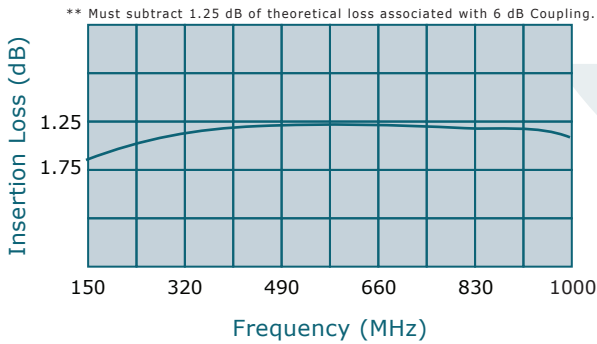
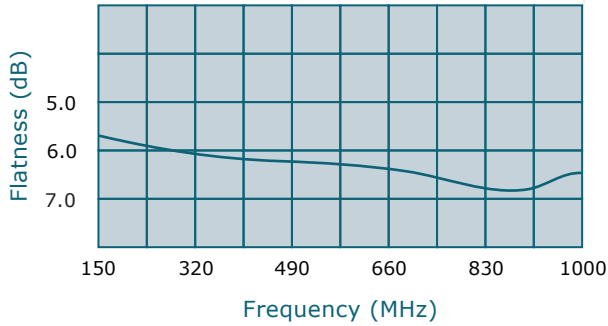

Frequency: 150 - 1000 MHz

Power: 350 W CW

Insertion Loss: 0.5 dB Max.

VSWR: 1.30:1 Max.

Flatness: 6 dB +/- 1.0 dB Max.

- Designed for Distributed Communications Systems.
- All specifications guaranteed.
- Test data provided with each unit shipped.

#### Connectors

| Model    | Input(J1)   | Output(J2)/Coupled Port |
|----------|-------------|-------------------------|
| C5878-10 | N Female    | N Female                |
| C5878-14 | N Male      | N Female                |
| C5878-24 | 7/16 Female | 7/16 Female             |

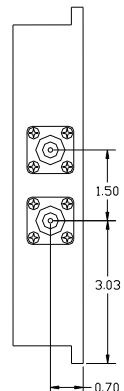
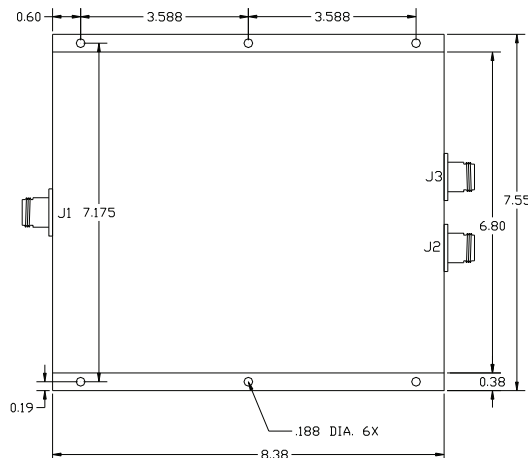
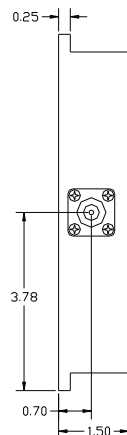

high power RF devices