



WERLATONE

SINCE 1965

Werlatone, Inc.
17 Jon Barrett Road
Patterson, New York 12563
T 845.278.2220
F 845.278.3440
www.werlatone.com



10 dB Dual Directional Coupler

Model C7008

Frequency: 20 - 180 MHz

Power: 100 W CW

Coupling: 10 dB \pm 1.0 dB Nom.

Insertion Loss: 1.0 dB Max.*

VSWR: 1.25:1 Max.

Flatness: +/- 0.5 dB Max.

Directivity: 20 dB Min.

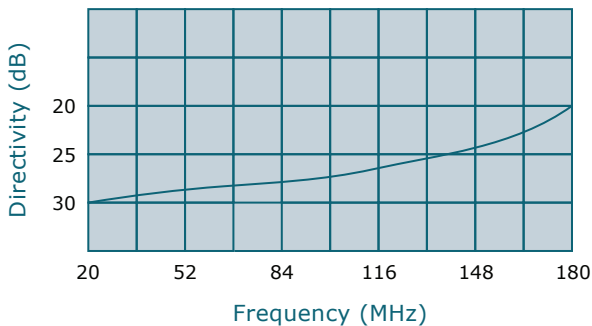
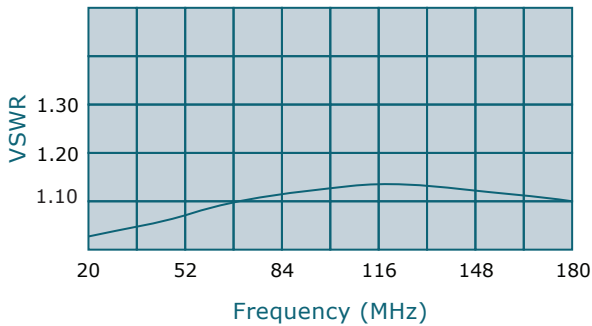
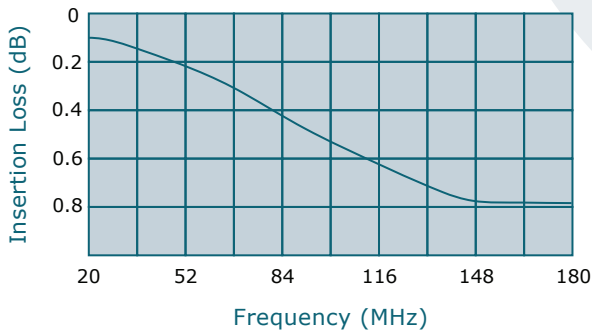
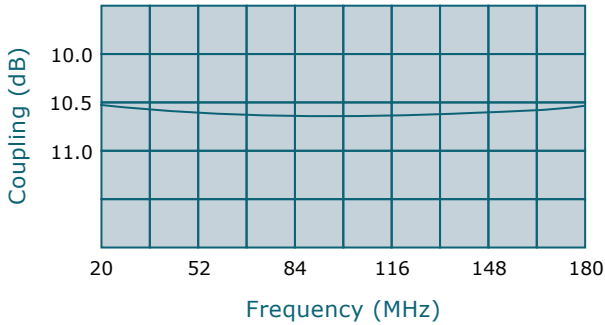

- * Does not include Theoretical Coupling Loss.
- All specifications guaranteed.
- Test data provided with each unit shipped.
- Uni-Directional version available.

Connector Configurations		
Model	J1,J2 (Mainline)	J3,J4 (Coupled Port)
C7008-10	N Female	N Female
C7008-12	N Female	SMA
C7008-13	N Female	BNC
C7008-102	SMA	SMA

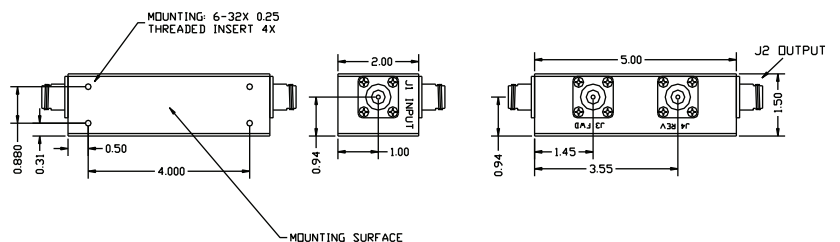

**Subject to change without notice