



PRODUCT DATA SHEET

H9395R

Werlatone® High Power 180° RF Hybrid Combiners/Dividers balance traditional technologies with disruptive microwave techniques. The outcome is a microwave component which provides an order of magnitude improvement over current capabilities. Our newest line of high power, patented 180° RF Hybrid Combiners/Dividers provides an incredible 5:1 bandwidth, while exhibiting exceptionally low loss and superior port-to-port isolation.

Features:

High Power Wide Bandwidths Small Size Excellent Amplitude Balance

Electrical Specifications:

Frequency: 350 - 1000 MHz
 Power: 250 W CW
 Insertion Loss: 0.3 dB Max.
 VSWR: 1.30:1 Max.
 Phase Balance: $180^\circ \pm 7^\circ$ Max.
 Amplitude Balance: ± 0.4 dB Max.
 Isolation: 20 dB Min.

Mechanical Specifications:

Type: Connectorized
 Material: Aluminum 6061-T6
 Surface Finish: Chem. Film Per MIL-DTL-5541F Type II Class 3 (RoHS Compliant)
 Operating Temperature: -55°C to +75°C
 Storage Temperature: -60°C to +85°C
 Size: 3.5 x 4.28 x 1.06"

Connector Configurations:

Model	Sum Port (J1)	Inputs/Outputs (J2,J3)	Diff. Port (J4)
H9395R-10	N Female	N Female	N Female

"R" references a fully RoHS Compliant Design

Werlatone's standard line of High Power 180° RF Hybrid Combiners/Dividers covers multiple octaves within a microwave device. Low frequency 180° Hybrid Combiner/Dividers employ proprietary ferrite transmission line techniques, similar to our 0° Combiners/Dividers. Insertion loss in both sum and difference ports is minimal, allowing the hybrid to handle high power over its frequency range. Custom requirements are welcome.

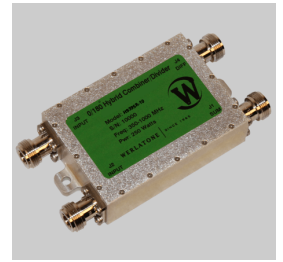

PRODUCT DATA SHEET

H9395R

Performance Data (Specifications subject to change without notice):

Coupling:

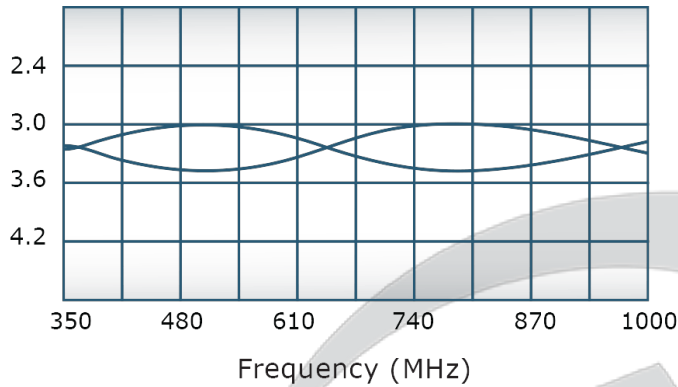

VSWR:

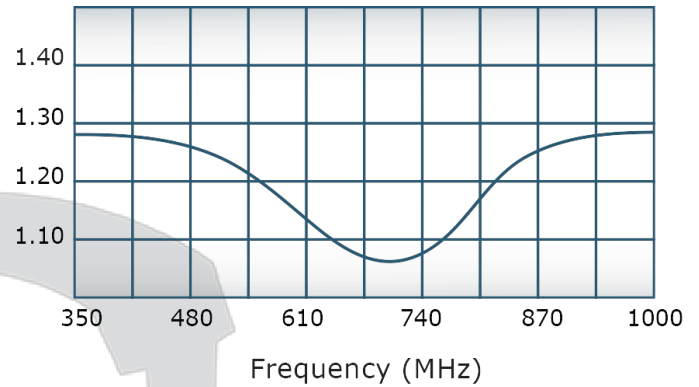

Isolation:

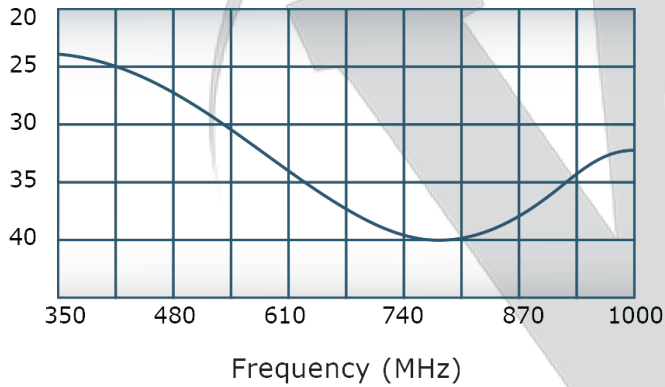

Phase Balance:

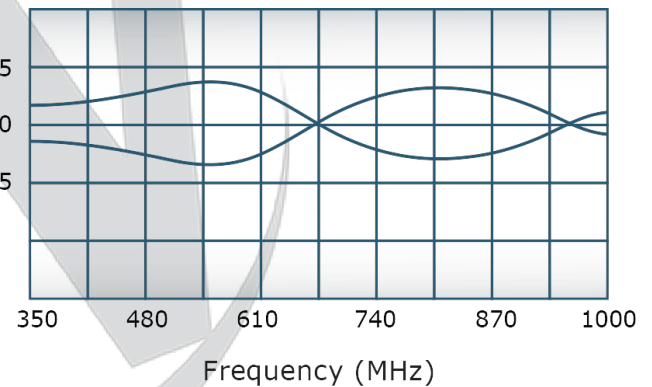

Restriction on use, duplication, or disclosure of proprietary information. This document contains proprietary information which is the sole property of Werlatone, Inc.

Werlatone, Inc. 17 Jon Barrett Road Patterson, NY 12563 T:(845)278-2220 F:(845)278-3440 sales@werlatone.com www.werlatone.com

RESTRICTION ON USE, DUPLICATION OR DISCLOSURE OF PROPRIETARY INFORMATION
This document contains proprietary information which is the sole property of Werlatone, Inc.

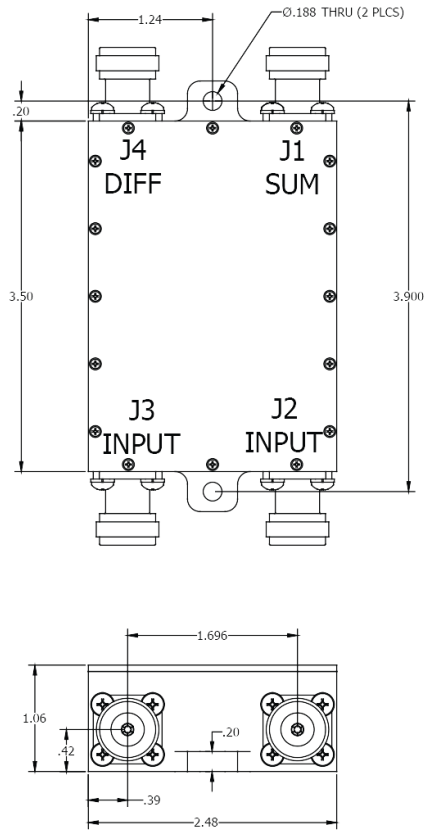

NOTES: UNLESS OTHERWISE SPECIFIED

1. MAT'L: ALUMINUM 6061-T6
2. FINISH: CHEM FILM PER-DTL-5541F TYPE 2 CLASS 3 (RoHS COMPLIANT)
3. CONNECTORS: N (FEMALE)

	A	B	C	D
1	REVISION HISTORY			
2	REV	REVISION RECORD	DATE	APPROVED
3	-	INITIAL RLS	5/23/2012	BW
4				
5				
6				

UNLESS OTHERWISE SPECIFIED		DWN	DATE	WERLATONE SINCE 1965 17 Jon Barrett Rd Patterson, NY 12563
<ul style="list-style-type: none"> • INTERPRET DRAWING IAW MIL-STD-100 • DIMENSIONING PER ASME Y14.5M-2009 • PARENTHEetical INFO FOR REF ONLY • DIMENSIONS ARE IN INCHES • DIMENSIONAL LIMITS APPLY BEFORE PROCESSES • TOLERANCES: ANGLES ± 2° 2 PL ± .005 2 PL ± .015 		NH	05/23/12	
THIRD ANGLE PROJECTION		CHK	DATE	OUTLINE TITLE SIZE A CAGE CODE 28812 DWG NO 20904-500 SCALE 1:2 SHEET 1 OF 1
		ENGR	DATE	
		BW	05/23/12	REV -
		MFGR	DATE	
		QA	DATE	
		RLSE	DATE	

Restriction on use, duplication, or disclosure of proprietary information. This document contains proprietary information which is the sole property of Werlatone, Inc.
Werlatone, Inc. 17 Jon Barrett Road Patterson, NY 12563 T:(845)278-2220 F:(845)278-3440 sales@werlatone.com www.werlatone.com