



PRODUCT DATA SHEET

H3670

Werlatone® High Power 180° RF Hybrid Combiners/Dividers balance traditional technologies with disruptive microwave techniques. The outcome is a microwave component which provides an order of magnitude improvement over current capabilities. Our newest line of high power, patented 180° RF Hybrid Combiners/Dividers provides an incredible 5:1 bandwidth, while exhibiting exceptionally low loss and superior port-to-port isolation.

Features:

High Power Wide Bandwidths Small Size Excellent Amplitude Balance

Electrical Specifications:

Frequency: 200 - 400 MHz
Power: 400 W CW
Insertion Loss: 0.2 dB Max.
VSWR: 1.40:1 Max.
Phase Balance: $180^\circ \pm 5^\circ$ Max.
Amplitude Balance: ± 0.2 dB Max.
Isolation: 20 dB Min.

Mechanical Specifications:

Type: Connectorized
Material: Aluminum 6061-T6
Surface Finish: Chem. Film Per MIL-DTL-5541F Type I Class 3 (Yellow Iridite) RoHS Compliant Available
Operating Temperature: -55°C to +75°C
Storage Temperature: -60°C to +85°C
Size: 5.0 x 3.0 x 2.24"

Connector Configurations:

Model	Sum Port (J1)	Input Port (J2)	Output Ports (J3,J4)
H3670-10	N Female	N Female	N Female
H3670-12	N Female	SMA	SMA
H3670-102	SMA	SMA	SMA

- Unit designed to operate continuously with one input failure at rated power.
- Unit designed to operate as a Non-Coherent Combiner at 200 W / input.
- Should the unit be used as a 0° In-Phase Combiner/Divider, J1 is the Input Port, J3 & J4 are the Output Ports, and J2 is the Load Port, in which the customer terminates it externally with a 50 Ohm Load.



WERLATONE

Model H3670
180° Hybrids Connectorized



PRODUCT DATA SHEET

H3670

Performance Data (Specifications subject to change without notice):

Insertion Loss:

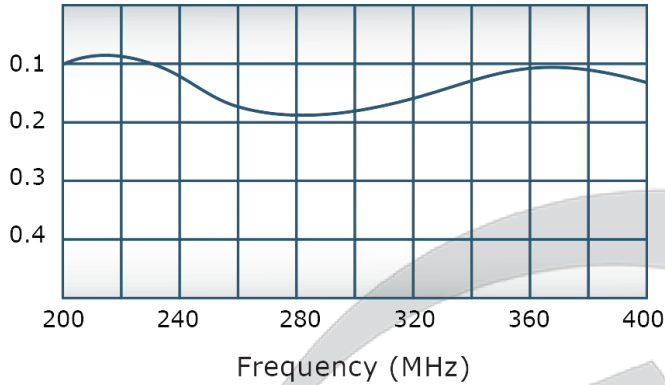

VSWR:

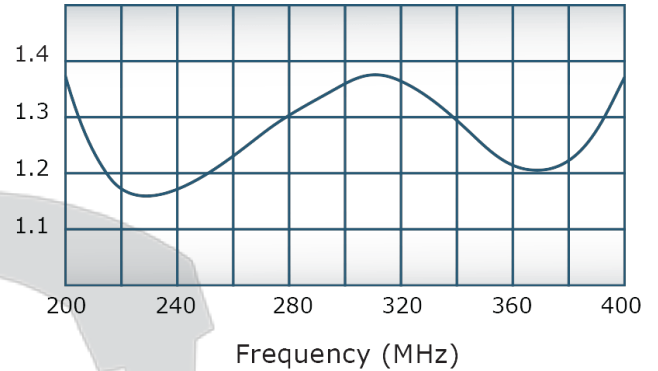

Isolation:

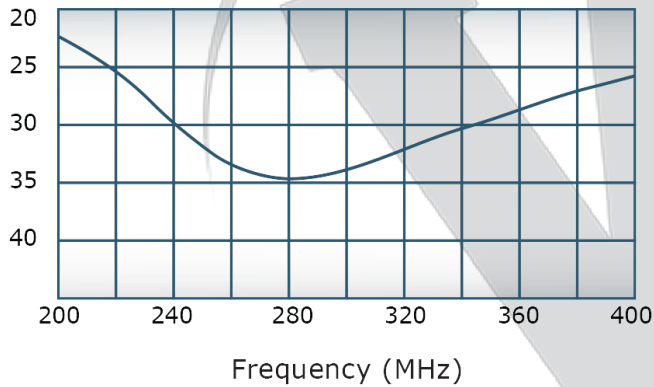

Phase Balance:

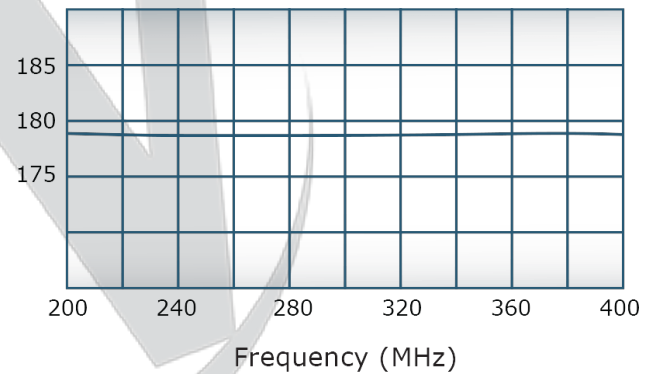

Restriction on use, duplication, or disclosure of proprietary information. This document contains proprietary information which is the sole property of Werlatone, Inc.

Werlatone, Inc. 17 Jon Barrett Road Patterson, NY 12563 T:(845)278-2220 F:(845)278-3440 sales@werlatone.com www.werlatone.com

DATE	SYM	REVISION RECORD	AUTH	DR	CK

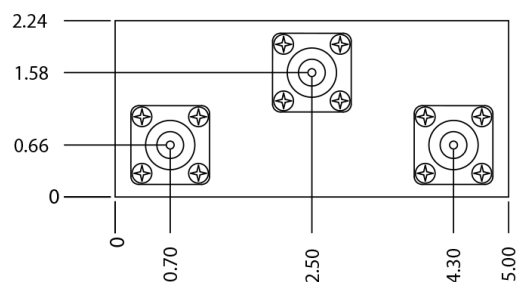
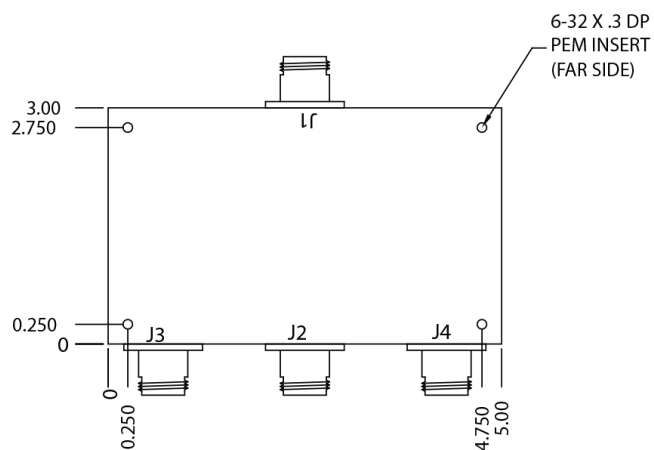
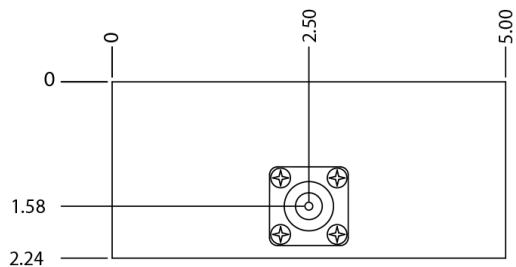

THIS DRAWING CONTAINS INFORMATION
PROPRIETARY TO WERLATONE INC. AND
MAY NOT BE USED OR COPIED WITHOUT
THE WRITTEN CONSENT OF WERLATONE INC.

TOLERANCE	WERLATONE INC.			
XX +/- .015 XXX +/- .005	USED ON:	SCALE	DRAWN BY: RH	APPVD BY: MJ
	TITLE OUTLINE			
	DATE 6/6/03	DRAWING NUMBER 10918-500		

Restriction on use, duplication, or disclosure of proprietary information. This document contains proprietary information which is the sole property of Werlatone, Inc.
Werlatone, Inc. 17 Jon Barrett Road Patterson, NY 12563 T:(845)278-2220 F:(845)278-3440 sales@werlatone.com www.werlatone.com