



PRODUCT DATA SHEET

WPM11379

Instantaneous & Simultaneous

- Local and/or Remote Monitoring
- Forward Power Reading/Monitoring (Watts or dBm)
- Reverse Power Reading/Monitoring (Watts or dBm)
- VSWR Readings (Watts, Return Loss, Rho)

VSWR Alarm

- Customer can set up audio/visual alarm via relay contacts.
- Signal sent to closed loop.

Temperature Monitoring (with alarm)

- One sensor, internal measurement, within Power Meter.
- One sensor, external measurement, to be placed by customer.

General Purpose Inputs (6 ea) Multiple Use

- Track switch closures (assign to interlock group).
- Trigger alarm relay (sends email alert).
- RF presence status/alarm (safety feature).
- Alarm, activated switch.

Accessories:

- Single Channel and Multi-Channel Displays
- RF Digital Dashboard Spreadsheet Software, (Simultaneously Monitor Outputs of 30+ Power Meters)
- PC Based Graphical User Interface Windows XP/7/8/10 Compatible

Accuracy:

- $\pm 2\%$ to Customer Calibration Standard, at preselected frequencies.
- $\pm 5\%$ over a Multi-Octave Bandwidth
- Werlatone Calibration Traceable to (NIST) National Institute of Standards and Technology

Power:

- AC Power Adapter (100/240 50-60 Hertz V AC)
- POE (Passive Over Ethernet, Optional POE Injector Kit Available)
- Via RS485 (Via Single Channel or Multi-Channel Displays)

Interface (Via):

- TCP/IP - SNMP and Browser Interface via Local Area Network
- RS232, Serial
- RS485 - Form Addressable Serial Network
- User ID and Password Protected for Access and Control
- Multiple units can be Networked and Simultaneously Monitored On-Site or Remotely (TCP/IP/SNMP/Serial)

RoHS Compliant Design Available
Custom Connector Configurations Available

Electrical Specifications:

Frequency: 100 - 500 MHz
Power: 2500 W CW

Mechanical Specifications:

Type: Connectorized
Operating Temperature: -55°C to $+75^{\circ}\text{C}$
Storage Temperature: -60°C to $+85^{\circ}\text{C}$

Connector Configurations:

| Model | Input(J1) | Output(J2) |
|-------------|-------------|-------------|
| WPM11379-22 | 7/16 Female | 7/16 Female |

RESTRICTION ON USE, DUPLICATION OR DISCLOSURE OF PROPRIETARY INFORMATION
This document contains proprietary information which is the sole property of Werlatone, Inc.

| REVISION HISTORY | | | |
|------------------|-----------------|------|----------|
| REV. | REVISION RECORD | DATE | APPROVED |
| | PRE-RELEASE | | |

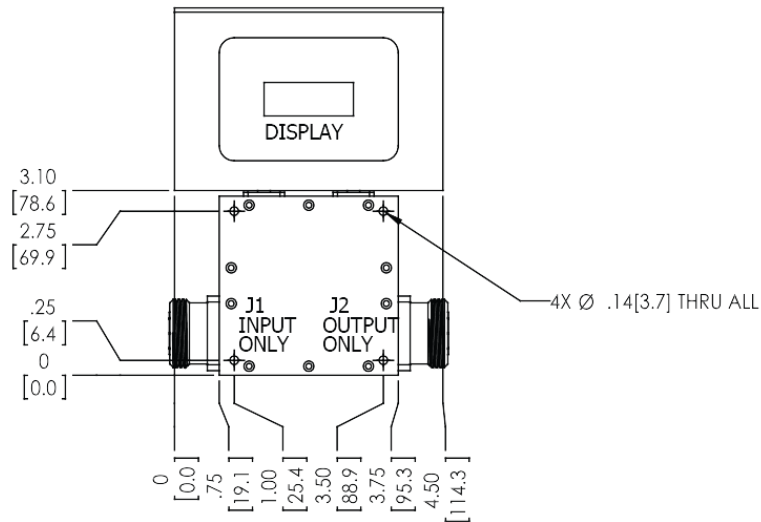
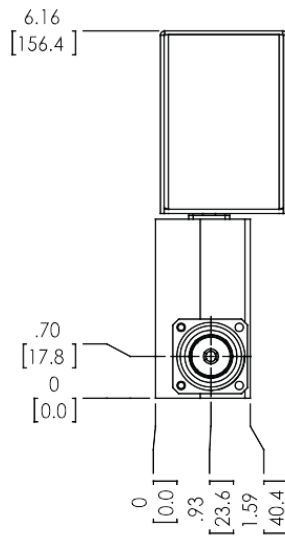
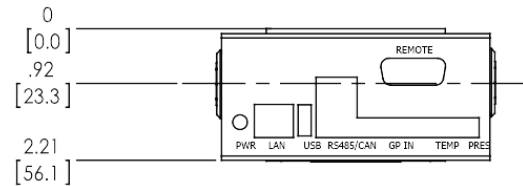

| | | | |
|---|---|--|--|
| UNLESS OTHERWISE SPECIFIED • INTERPRET DRAWING IN ACC. WITH STD-309 • DIMENSIONS GIVEN PER ASME Y14.5-2000 • PARALLELITY, PERPENDICULARITY, ETC. • DIMENSIONS ARE IN BRACKETS (INCHES) • DIMENSIONAL LIMITS APPLY BEFORE PROCESSING • TOLERANCES: ANGLES: 4:20 2 IN. & OVER: 1:20 2 IN. & OVER: 1:20 2 IN. & OVER: 1:20 • REMOVE ALL BURRS AND SHARP EDGES B.L. MAX. • CONCENTRICITY MAXIMUM DIA. .001 DIA. • FINISH: TOOK, HEDMACH & MAX. | | PWN DATE 3/28/2017 | 17 Jon Barrett Rd Patterson, NY 12563 |
| TRD NEXT ASSY USED ON | PLP DATE ENGR DATE PPRC DATE QA DATE FILE DATE | TITLE SIZE B 28812 CAGE CODE 21511-501 OWG NO SCALE 1:2 | REV PO SHEET 1 OF 1 |
| APPLICATION THIRD ANGLE PROJECTION | | | |

Restriction on use, duplication, or disclosure of proprietary information. This document contains proprietary information which is the sole property of Werlatone, Inc. Werlatone, Inc. 17 Jon Barrett Road Patterson, NY 12563 T:(845)278-2220 F:(845)278-3440 sales@werlatone.com www.werlatone.com