



## PRODUCT DATA SHEET

C7530

**3-Port Uni-Directional Coupler:** Consists of a main line and a coupled line. One end of the coupled line is internally terminated, while the other end serves as a coupled port. Ideal for sampling and monitoring power in one direction at a given time. It is necessary to physically reverse the orientation of the unit to change from a forward to a reverse power measurement.

### Features:

High Power      Wide Bandwidths      Small Size      Flat Coupling      Custom Designs Available

### Electrical Specifications:

Frequency: 300 - 3000 MHz  
 Power: 100 W CW  
 Coupling:  $20 \pm 1.0$  dB Max.  
 Insertion Loss: 0.35 dB Max.  
 Flatness:  $\pm 1.0$  dB Max.  
 VSWR (ML): 1.20:1 Max.  
 Directivity: 18 dB Min.

### Mechanical Specifications:

Type: Connectorized  
 Material: Aluminum 6061-T6  
 Surface Finish: Chem. Film Per MIL-DTL-5541F  
 Type I Class 3 (Yellow Iridite)  
 RoHS Compliant Available  
 Operating Temperature: -55°C to +75°C  
 Storage Temperature: -60°C to +85°C  
 Humidity: 95% Non-Condensing  
 Size: 3.7 x 2.0 x 0.75"  
 Weight: 0.5 lbs.

### Connector Configurations:

Model	Input (J1)	Output (J2)	Fwd (J3)
C7530-10	N Female	N Female	N Female
C7530-12	N Female	N Female	SMA
C7530-102	SMA	SMA	SMA

**Werlatone®** Broadband Dual, Uni, and Bi Directional RF Couplers are designed to tolerate the most stringent operating conditions associated with military and EMC testing environments. Many of our RF Directional Couplers, designated Mismatch Tolerant®, will operate continuously, at rated power, into a severe load mismatch condition. Our multi-octave Directional Couplers maintain exceptional coupling flatness, directivity, VSWR, and insertion loss.



# WERLATONE

Model C7530

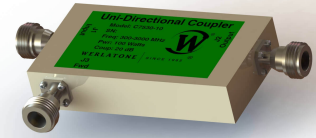

## PRODUCT DATA SHEET

C7530

### Performance Data (Specifications subject to change without notice):

Coupling:

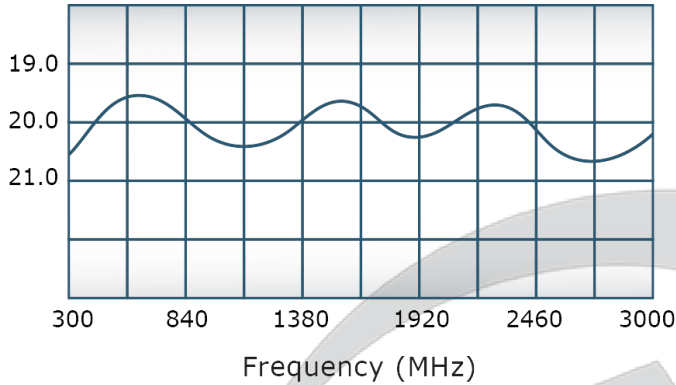

VSWR:

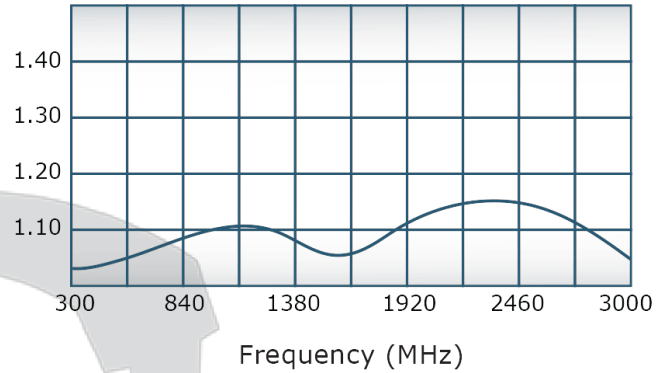

Insertion Loss:

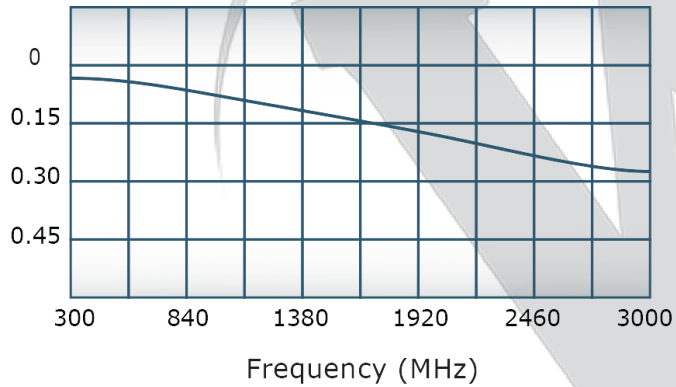

Directivity:

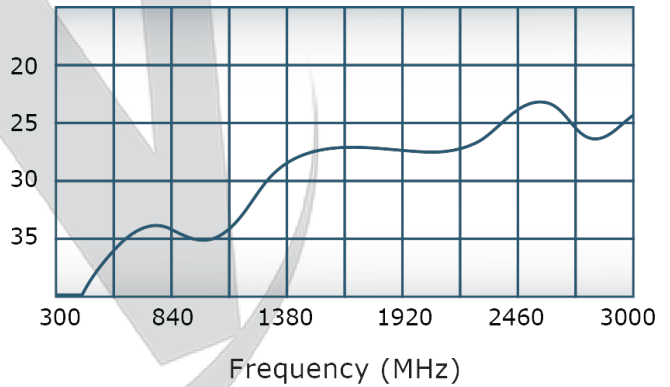

**Restriction on use, duplication, or disclosure of proprietary information.** This document contains proprietary information which is the sole property of Werlatone, Inc.

Werlatone, Inc. 17 Jon Barrett Road Patterson, NY 12563 T:(845)278-2220 F:(845)278-3440 sales@werlatone.com www.werlatone.com

**RESTRICTION ON USE, DUPLICATION OR DISCLOSURE OF PROPRIETARY INFORMATION**  
 This document contains proprietary information which is the sole property of Werlatone, Inc.

REVISION HISTORY			
REV.	REVISION RECORD	DATE	APPROVED
A	ECN 9696	7/6/2020	RB

**NOTES: UNLESS OTHERWISE SPECIFIED**

- MATERIAL: ALUMINUM 6061-T6**
- FINISH: CHEM FILM PER MIL-DTL-5541F TYPE I CLASS 3 (YELLOW IRIDITE)**
- CONNECTORS:**  
**J1-J3: N FEMALE**

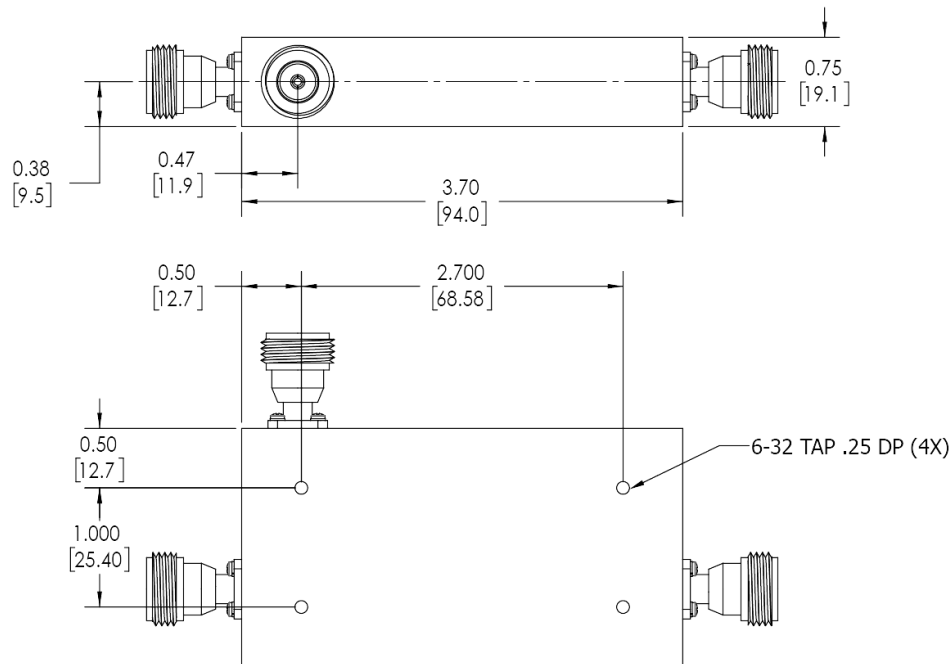
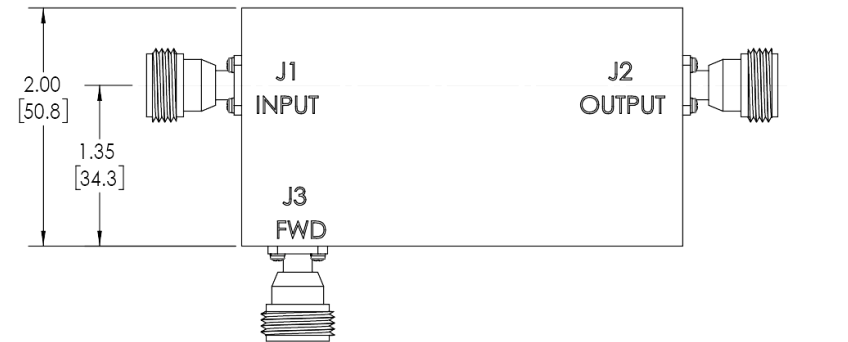

UNLESS OTHERWISE SPECIFIED		OWN	DATE	SD		DATE	17 Jon Barrett Rd	
INTERPRET DRAWING IN ACCORDANCE WITH MIL-STD-100		CHK	DATE	CS		DATE	Patterson, NY 12563	
DIMENSIONS PER ASME Y14.5M-2009		ENGR	DATE	DATE		DATE	TITLE	
PARENTHESES FOR REF ONLY		DATE	DATE	DATE		DATE	WERLATONE SINCE 1965	
DIMENSIONS ARE IN INCHES		DATE	DATE	DATE		DATE	OUTLINE	
DIMENSIONAL LIMITS APPLY BEFORE FINISHES		DATE	DATE	DATE		DATE	SIZE CAGE CODE DWG NO	
TOLERANCES:		DATE	DATE	DATE		DATE	B 20178-500	
ANGLES ± 2°		DATE	DATE	DATE		DATE	REV	
3 PL ± .005 [13]		DATE	DATE	DATE		DATE	A	
2 PL ± .015 [38]		DATE	DATE	DATE		DATE	SCALE	
REMOVE ALL BURRS AND SHARP EDGES R.01 MAX		DATE	DATE	DATE		DATE	1:1	
CONCENTRICITY MACHINED DIA. .002 FIM		DATE	DATE	DATE		DATE	SHEET 1 OF 1	
MACHINE TOOL MISMATCH .003 FIM		DATE	DATE	DATE		DATE		
THIRD ANGLE PROJECTION		DATE	DATE	DATE		DATE		
APPLICATION		DATE	DATE	DATE		DATE		

**Restriction on use, duplication, or disclosure of proprietary information.** This document contains proprietary information which is the sole property of Werlatone, Inc.  
 Werlatone, Inc. 17 Jon Barrett Road Patterson, NY 12563 T:(845)278-2220 F:(845)278-3440 sales@werlatone.com www.werlatone.com