



## PRODUCT DATA SHEET

WPM11490

### Instantaneous & Simultaneous

- Local and/or Remote Monitoring
- Forward Power Reading/Monitoring (Watts or dBm)
- Reverse Power Reading/Monitoring (Watts or dBm)
- VSWR Readings (Watts, Return Loss, Rho)

### VSWR Alarm

- Customer can set up audio/visual alarm via relay contacts.
- Signal sent to closed loop.

### Temperature Monitoring (with alarm)

- One sensor, internal measurement, within Power Meter.
- One sensor, external measurement, to be placed by customer.

### General Purpose Inputs (6 ea) Multiple Use

- Track switch closures (assign to interlock group).
- Trigger alarm relay (sends email alert).
- RF presence status/alarm (saftey feature).
- Alarm, activated switch.

### Accessories:

- Single Channel and Multi-Channel Displays
- RF Digital Dashboard Spreadsheet Software, (Simultaneously Monitor Outputs of 30+ Power Meters)
- PC Based Graphical User Interface Windows XP/7/8/10 Compatible

### Accuracy:

- $\pm 2\%$  to Customer Calibration Standard, at preselected frequencies.
- $\pm 5\%$  over a Multi-Octave Bandwidth
- Werlatone Calibration Traceable to (NIST) National Institute of Standards and Technology

### Power:

- AC Power Adapter (100/240 50-60 Hertz V AC)
- POE (Passive Over Ethernet, Optional POE Injector Kit Available)
- Via RS485 (Via Single Channel or Multi-Channel Displays)

### Interface (Via):

- TCP/IP - SNMP and Browser Interface via Local Area Network
- RS232, Serial
- RS485 - Form Addressable Serial Network
- User ID and Password Protected for Access and Control
- Multiple units can be Networked and Simultaneously Monitored On-Site or Remotely (TCP/IP/SNMP/Serial)

RoHS Compliant Design Available  
Custom Connector Configurations Available

### Electrical Specifications:

Frequency: 10 - 127 MHz  
Power: 20,000 W CW

### Calibrated to Exact Frequencies:

12.882 MHz    13.56 MHz    14.238 MHz  
57.0 MHz    60.0 MHz    63.00 MHz  
127.00 MHz

### Mechanical Specifications:

Type: Connectorized  
Operating Temperature: -55°C to +75°C  
Storage Temperature: -60°C to +85°C

### Connector Configurations:

Model	Input(J1)	Output(J2)
WPM11490-502	SQS Female	SQS Female
WPM11490-7502	SQS Male	SQS Female
WPM11490-QC-2	QC Block	QC Block

**RESTRICTION ON USE, DUPLICATION OR DISCLOSURE OF PROPRIETARY INFORMATION**  
This document contains proprietary information which is the sole property of Werlatone, Inc.

REVISION HISTORY			
REV.	REVISION RECORD	DATE	APPROVED
-	INITIAL RELEASE	2/12/2018	CS

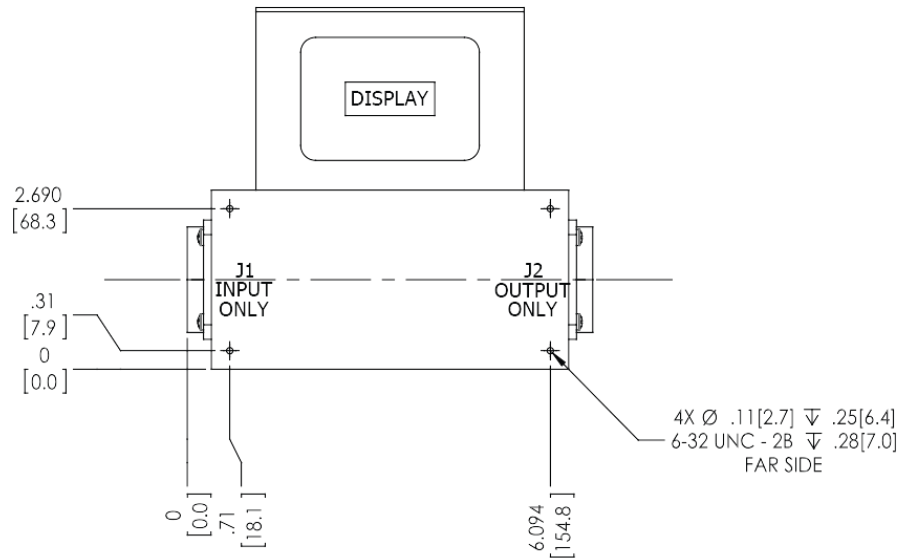
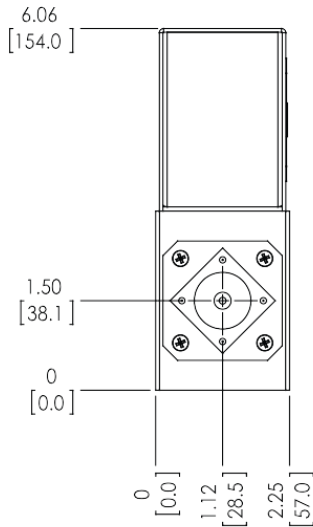
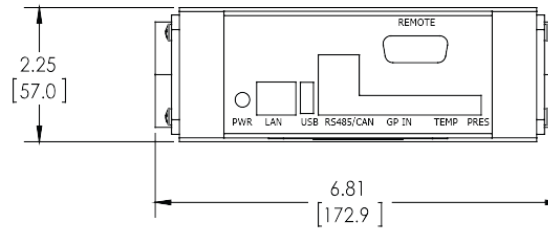

UNLESS OTHERWISE SPECIFIED		OWN	PLP	DATE	2/9/2018
• INTERPRET DRAWING IN ACCORDANCE WITH ASME Y14.5-2009		CHK	CS	DATE	2/9/2018
• DIMENSIONS ARE IN INCHES (MM)		ENG	DATE		
• TOLERANCES:		INSTR	DATE		
• ANGLES: 1:2		QA	DATE		
• REMOVE ALL BURRS AND SHARP EDGES 0.01 MAX		REL	DATE		
• CONCENTRICITY MACHINED DIA. 0.02 FIM					
• MACHINE TOOL IDENTIFICATION: 0.02 FIM					
THIRD ANGLE PROJECTION					
APPLICATION					
NEXT ASSY USED ON					
WPM11416					
TITLE					
OUTLINE					
SIZE					
B 28812					
CAGE CODE					
21583-500					
SCALE					
1:2					
SHEET 1 OF 1					

Restriction on use, duplication, or disclosure of proprietary information. This document contains proprietary information which is the sole property of Werlatone, Inc.  
Werlatone, Inc. 17 Jon Barrett Road Patterson, NY 12563 T:(845)278-2220 F:(845)278-3440 sales@werlatone.com www.werlatone.com